

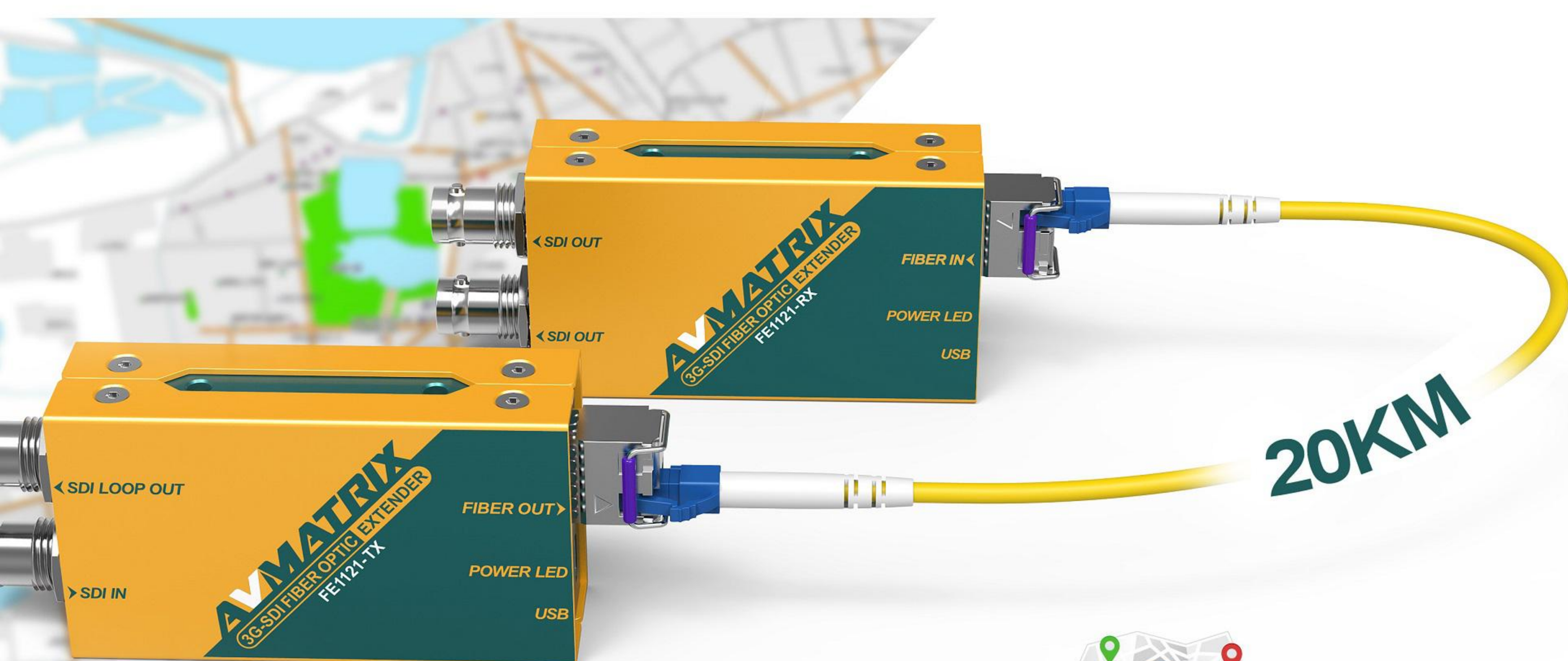

Model NO: **FE1121**
3G-SDI FIBER OPTIC EXTENDER

- ▶ 20km transmission distance
- ▶ Support 3Gbit Level A and Level B (all formats)
- ▶ SFP/ LC Fiber transmitter & receiver
- ▶ SDI equalization and re-clocking
- ▶ 3G-SDI input & loopout on transmitter
- ▶ Dual 3G-SDI outputs on receiver
- ▶ SDI input automatic switching SD, HD & 3G
- ▶ USB power supply



20km Transmission

The 3G-SDI Fiber Optic Extender is a transmitter/receiver kit supporting 1490nm wavelength single-mode LC simplex fiber extensions up to 20km. It is a miniature-style extension solution that supports all SDI formats resolutions up to 1080p (Max. bandwidth: 3Gbps) with audio and metadata.

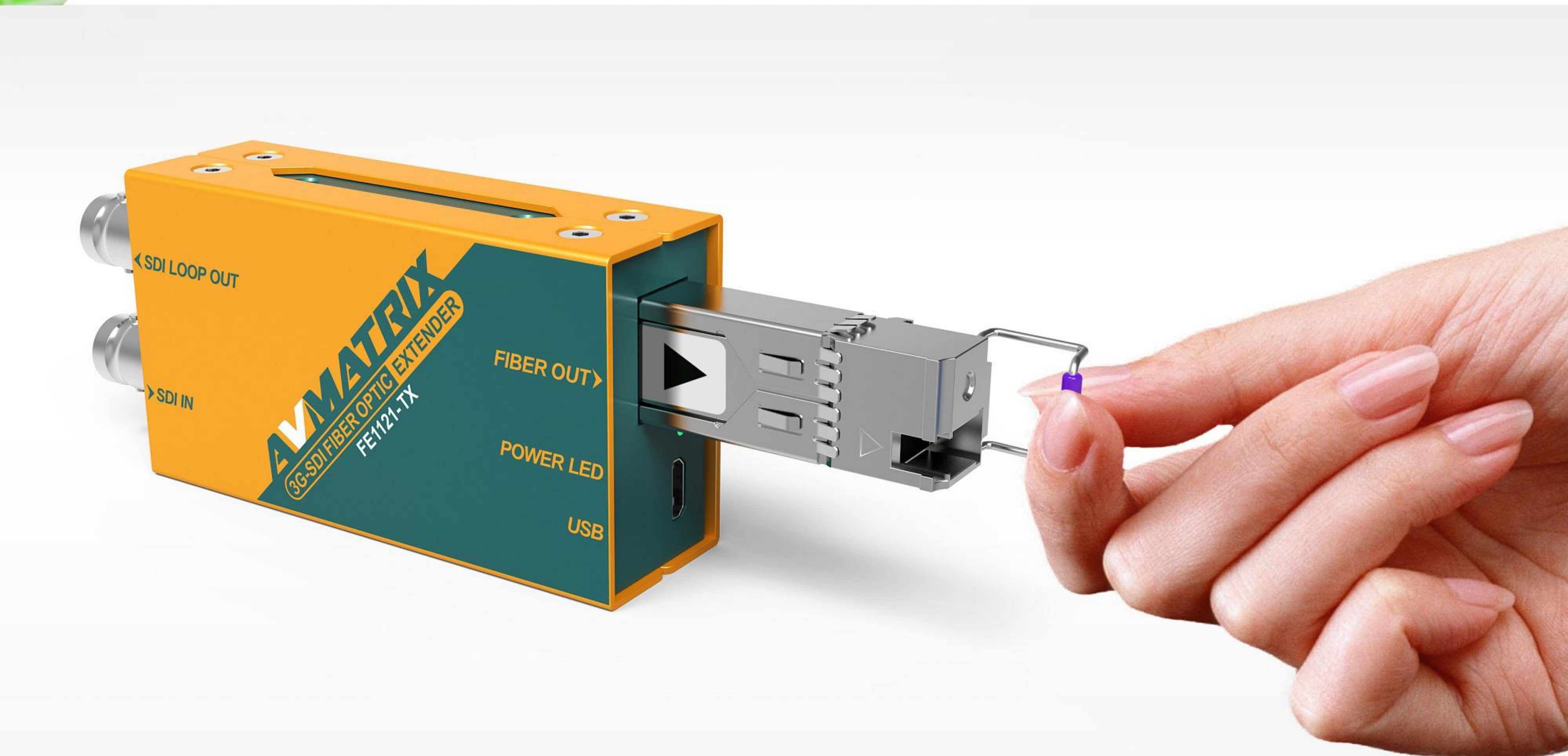

SFP module with LC connector

The fiber extender uses hot-pluggable SFP design with LC connector. You can replace the module anytime and anywhere. It is designed to transmit data rates from 50Mbps to 3Gbps, compliant with SFP MSA , SFF-8472 and SMPTE 297M-2006.

Eye Diagram

120M

SDI Equalization & Re-clocking

Equalized on the SDI input and reclocking on the SDI outputs to maximize performance up to 120m for 3G and 140m for HD-SDI. It ensures transmission quality and effect of eye diagram, and fully compatible with 3G level A & level B formats.

Technical specification

CONNECTIONS	Transmitter SDI Video Input	SD/HD/3G-SDI(75Ω)×1
	Transmitter SDI Loop Output	SD/HD/3G-SDI(75Ω)×1
	Transmitter Fiber Optical Output	SFP module(LC)×1
	Receiver Fiber Optical Input	SFP module(LC)×1
STANDARDS	Receiver SDI Video Output	SD/HD/3G-SDI(75Ω)×2
	Optical Fiber Module	SFP module: Hot-pluggable Connector style: LC Fiber type: single-mode Optical wavelength: 1490nm Max. bandwidth: 3Gbps Optical transmit power: -6~0dBm Receiver sensitivity: -22dBm
SDI Compliance	Single-mode Max. Distance	20 km (12.5 miles) for 3G (1080P)
	Optical Fiber Compliance	SMPTE 297M 2006
	SDI Compliance	3Gbit Level A & level B (all formats) SMPTE 259M, SMPTE 292M, SMPTE 424M, SMPTE 296M, SMPTE 274M, SMPTE 425M, ITU-R BT.656, ITU-R BT.601
	SDI Auto Switching	Auto selects SD/HD/3G-SDI on input
SDI Video Rate	SDI Video Rate	SD/HD/3G-SDI
	SDI Color Space	YUV, RGB
	SDI Equalization and Re-clocking	Yes, SDI input and output support up to 120m for 3G-SDI
	SDI Audio	Supports 16 channels embedded
SIZE	Dimension(LWD)	71×41×23mm
	Weight	200+200g
POWER	Power	Micro USB
	Power Consumption	1.5W
ENVIRONMENT	Voltage Range	3.3V~5V
	Operating Temperature	-20℃~60℃
WARRANTY	Storage Temperature	-30℃~70℃
	Relative Humidity	0%~90% non-condensing
Warranty		3 year limited warranty

